

Rekonstruktion der Bach Chororgel für St. Michaelis zu Lüneburg 2000

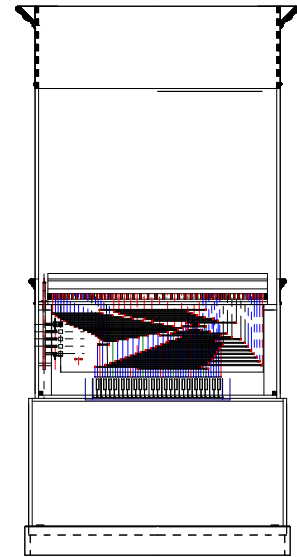
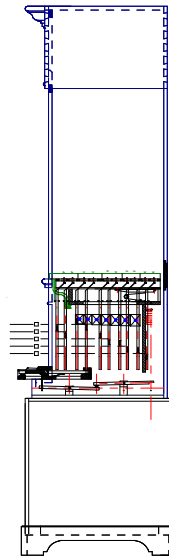

Manual C – d³

Gedact 8´
Principal 4´
Octave 2´
Sesquialter II
Krummhorn 8´

Tremulant
Transponiervorrichtung 415/440/465Hz

Orgelbaumeister Martin ter Haseborg
Am Industriepark 12 26670 Uplengen / Ostfriesland